

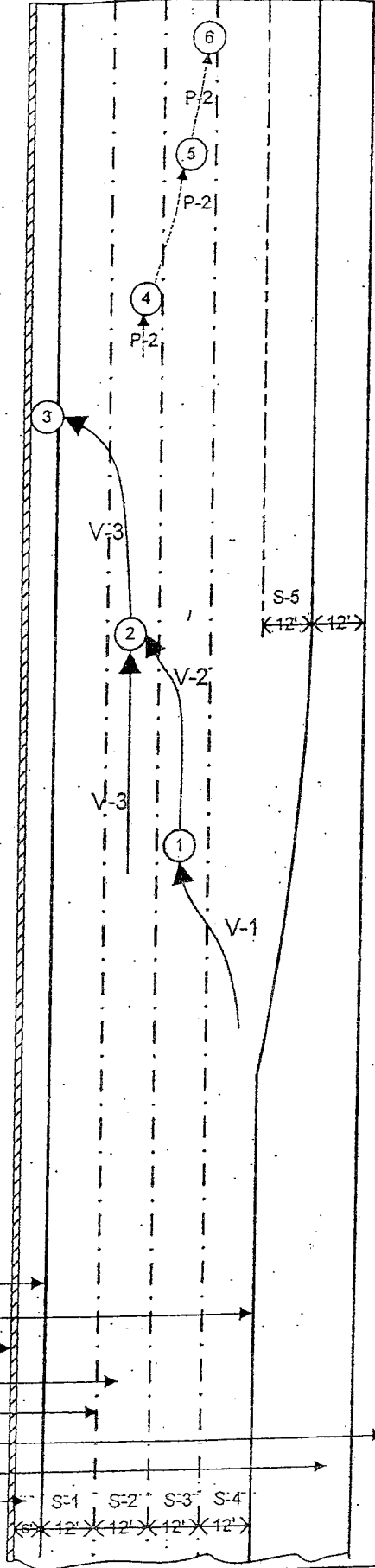

SKETCH  
(Not to Scale)

I-880 Southbound

↑  
66<sup>TH</sup> AVE. O/C



**Legend:**

- A: Solid yellow painted line
- B: Solid white painted line
- C: Concrete Barrier Wall
- D: Asphalt Roadway
- E: Broken white lines with Botts Dots
- F: Dirt/Shrub Field with Fence
- G: Right Shoulder
- H: Center Median

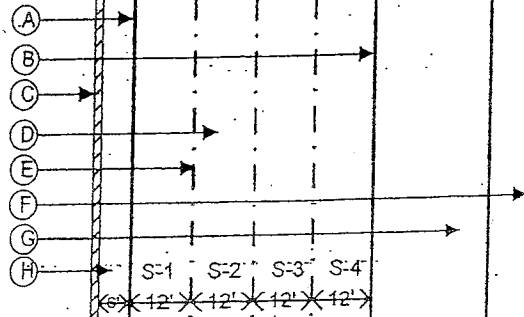

**FACTUAL DIAGRAM**

DATE OF INCIDENT  
07/10/2011

TIME  
0300

NCIC NUMBER  
9370

OFFICER I.D.  
02014

NUMBER  
070072



**FACTUAL**  
(Not to Scale)

I-880 Southbound

66<sup>TH</sup> AVE. O/C

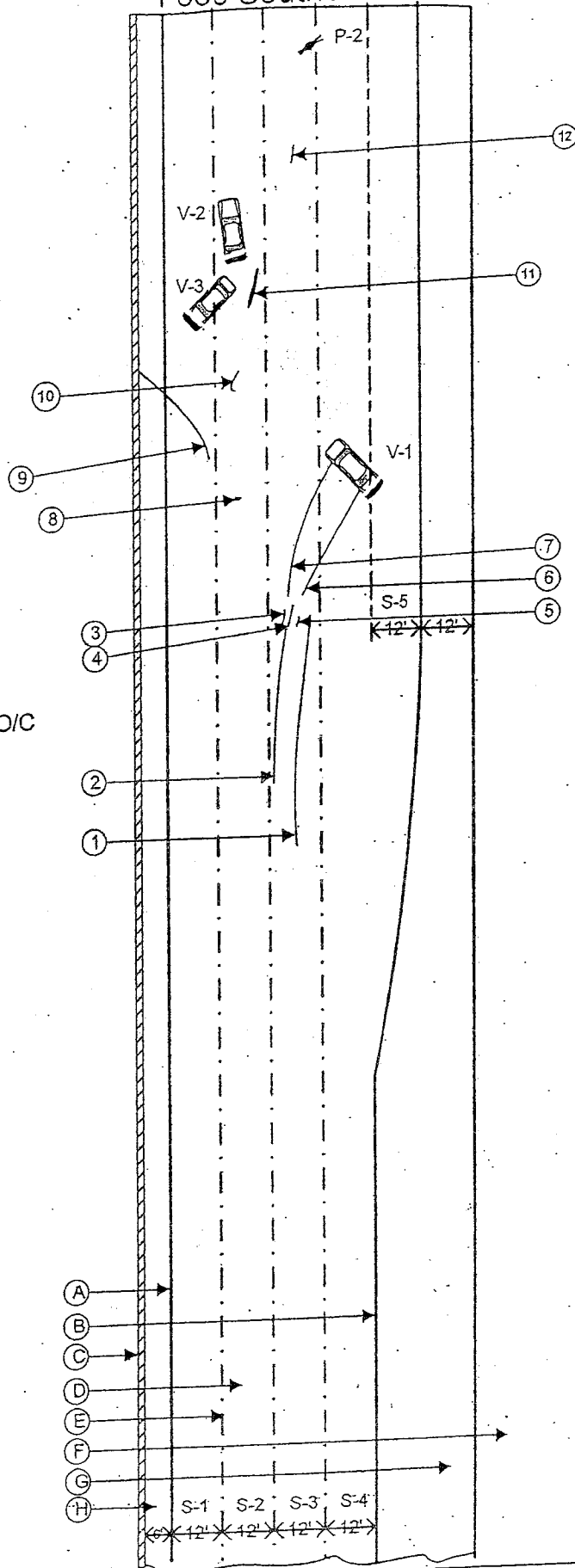

**Legend:**

- A: Solid yellow painted line
- B: Solid white painted line
- C: Concrete Barrier Wall
- D: Asphalt Roadway
- E: Broken white lines with Botts Dots
- F: Dirt/Shrub Field with Fence
- G: Right Shoulder
- H: Center Median

PREPARER'S NAME  
R. HARTMAN

I.D. NUMBER  
019156

DATE  
07/10/2011

REVIEWER'S NAME

DATE

DATE OF INCIDENT 07/10/2011	TIME 0300	NCIC NUMBER 9370	OFFICER I.D. 020145	NUMBER 070072
--------------------------------	--------------	---------------------	------------------------	------------------

POINTS OF REST							
VEH	WHEEL	HT	DIR	REFERENCE POINT	FEET	DIR	SECOND REFERENCE POINT
V-1	RR	1294	N	Of the 66 <sup>TH</sup> Avenue O/C	46	W	Of the concrete center median wall
	RF	1301	N	Of the 66 <sup>TH</sup> Avenue O/C	53	W	Of the concrete center median wall
V-2	LR	1245	N	Of the 66 <sup>TH</sup> Avenue O/C	21	W	Of the concrete center median wall
	LF	1235	N	Of the 66 <sup>TH</sup> Avenue O/C	20	W	Of the concrete center median wall
V-3	LR	1255	N	Of the 66 <sup>TH</sup> Avenue O/C	22	W	Of the concrete center median wall
	LF	1261	N	Of the 66 <sup>TH</sup> Avenue O/C	16	W	Of the concrete center median wall
P-2	HEAD	1199	N	Of the 66 <sup>TH</sup> Avenue O/C	39	W	Of the concrete center median wall
	WAIST	1198	N	Of the 66 <sup>TH</sup> Avenue O/C	40	W	Of the concrete center median wall
	FEET	1196	N	Of the 66 <sup>TH</sup> Avenue O/C	45	W	Of the concrete center median wall

PHYSICAL EVIDENCE
1: Tire Friction Mark
2: Tire Friction Mark
3: Gouge Mark 4' in length
4: Gouge Mark 5' in length
5: Gouge Mark 2' in length
6: Tire Friction Mark
7: Tire Friction Mark
8: Gouge Mark
9: Tire Friction Mark
10: Gouge Mark
11: Blood Stain
12: Blood Stain

PREPARED BY R. HARTMAN	ID. NUMBER 019156	DATE 07/10/2011	REVIEWER'S NAME	DATE
---------------------------	----------------------	--------------------	-----------------	------

DATE OF INCIDENT 07/10/2011	TIME 0300	NCIC NUMBER 9370	OFFICER I.D. 020145	NUMBER 070072
--------------------------------	--------------	---------------------	------------------------	------------------

LOCATION OF PHYSICAL EVIDENCE						
#	FT	DIR	REFERENCE POINT	FT	DIR	SECOND REFERENCE POINT
1a	1503	N	Of the 66 <sup>TH</sup> Avenue O/C	38	W	Of the concrete center median wall
1b	1489	N	Of the 66 <sup>TH</sup> Avenue O/C	38	W	Of the concrete center median wall
1c	1450	N	Of the 66 <sup>TH</sup> Avenue O/C	41	W	Of the concrete center median wall
2a	1488	N	Of the 66 <sup>TH</sup> Avenue O/C	32	W	Of the concrete center median wall
2b	1453	N	Of the 66 <sup>TH</sup> Avenue O/C	35	W	Of the concrete center median wall
3	1332	N	Of the 66 <sup>TH</sup> Avenue O/C	34	W	Of the concrete center median wall
4	1332	N	Of the 66 <sup>TH</sup> Avenue O/C	36	W	Of the concrete center median wall
5	1332	N	Of the 66 <sup>TH</sup> Avenue O/C	38	W	Of the concrete center median wall
6a	1325	N	Of the 66 <sup>TH</sup> Avenue O/C	40	W	Of the concrete center median wall
6b	1309	N	Of the 66 <sup>TH</sup> Avenue O/C	45	W	Of the concrete center median wall
6c	1297	N	Of the 66 <sup>TH</sup> Avenue O/C	52	W	Of the concrete center median wall
7a	1325	N	Of the 66 <sup>TH</sup> Avenue O/C	36	W	Of the concrete center median wall
7b	1315	N	Of the 66 <sup>TH</sup> Avenue O/C	40	W	Of the concrete center median wall
7c	1303	N	Of the 66 <sup>TH</sup> Avenue O/C	45	W	Of the concrete center median wall
8	1422	N	Of the 66 <sup>TH</sup> Avenue O/C	23	W	Of the concrete center median wall
9a	1412	N	Of the 66 <sup>TH</sup> Avenue O/C	17	W	Of the concrete center median wall
9b	1403	N	Of the 66 <sup>TH</sup> Avenue O/C	12	W	Of the concrete center median wall
9c	1391	N	Of the 66 <sup>TH</sup> Avenue O/C	0	W	Of the concrete center median wall
10a	1397	N	Of the 66 <sup>TH</sup> Avenue O/C	23	W	Of the concrete center median wall
10b	1395	N	Of the 66 <sup>TH</sup> Avenue O/C	23	W	Of the concrete center median wall
10c	1392	N	Of the 66 <sup>TH</sup> Avenue O/C	24	W	Of the concrete center median wall
11a	1257	N	Of the 66 <sup>TH</sup> Avenue O/C	27	W	Of the concrete center median wall
11b	1248	N	Of the 66 <sup>TH</sup> Avenue O/C	29	W	Of the concrete center median wall
12	1224	N	Of the 66 <sup>TH</sup> Avenue O/C	37	W	Of the concrete center median wall

PREPARED BY R. HARTMAN	ID. NUMBER 019156	DATE 07/10/2011	REVIEWER'S NAME	DATE
---------------------------	----------------------	--------------------	-----------------	------